

# FUSE CLIPS

## FOR FERRULE FUSES / PC BOARD MOUNT

### 30A & 60A FERRULE - FUSE CLIPS

#### Fuse Clips for 30 & 60 Ampere Ferrule-type Fuses

CAT. NO.	FIG.	FOR FUSE RATING/SIZE:		MOUNTING DETAILS	
		AMPS (max.)	FERRULE DIA.	HOLE SIZE	SCREW SIZE
C08915P	1	30	13/32"	.172" dia.	#8
C08919P	2	30	13/32"	.196" dia.	#10
C08916P	3	30	9/16"	.172" dia.	#8
C08917P	4	30 or 60	13/16"	.22" x .30"	#10
C08918P	5	60	1-1/16"	.22" x .30"	#10

All clips are UL Recognized: Guide IZLT2, File E52283  
 All clips are tin-plated copper alloy, non-spring reinforced.

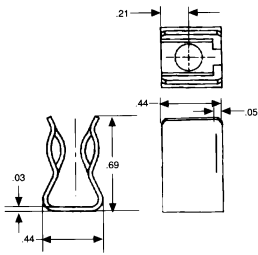

FIGURE 1

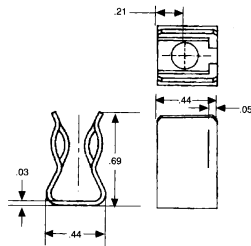

FIGURE 2

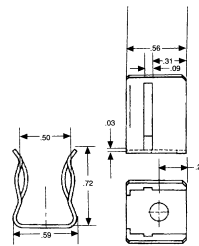

FIGURE 3

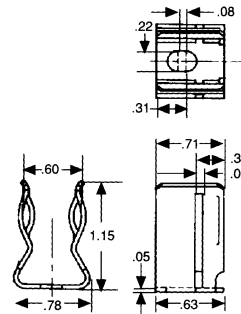

FIGURE 4

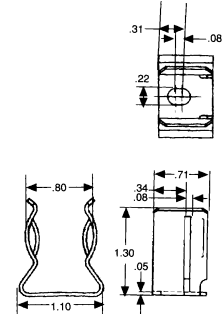
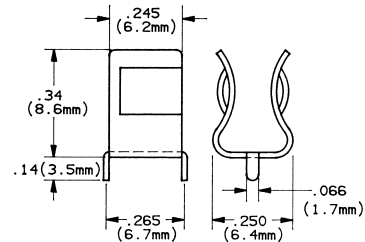

FIGURE 5



### SDC6 PC BOARD CLIPS

- PC board mount fuse clip
- For 1/4" diameter fuses
- Tin plated hard brass



### SDC5 PC BOARD CLIPS

- PC board mount fuse clip
- For 5mm diameter fuses
- Tin plated hard brass

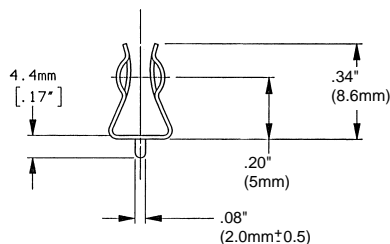

### SDC7 PC BOARD CLIPS

- PC board mount fuse clip
- For 13/32" (10mm) diameter fuses
- Tin plated spring brass

